

STAGE PLOT

- rev 101818

CONTACT INFO:
T: 323.334.0340
E: info@prismaticmusic.com
W: PrismaticMusic.com

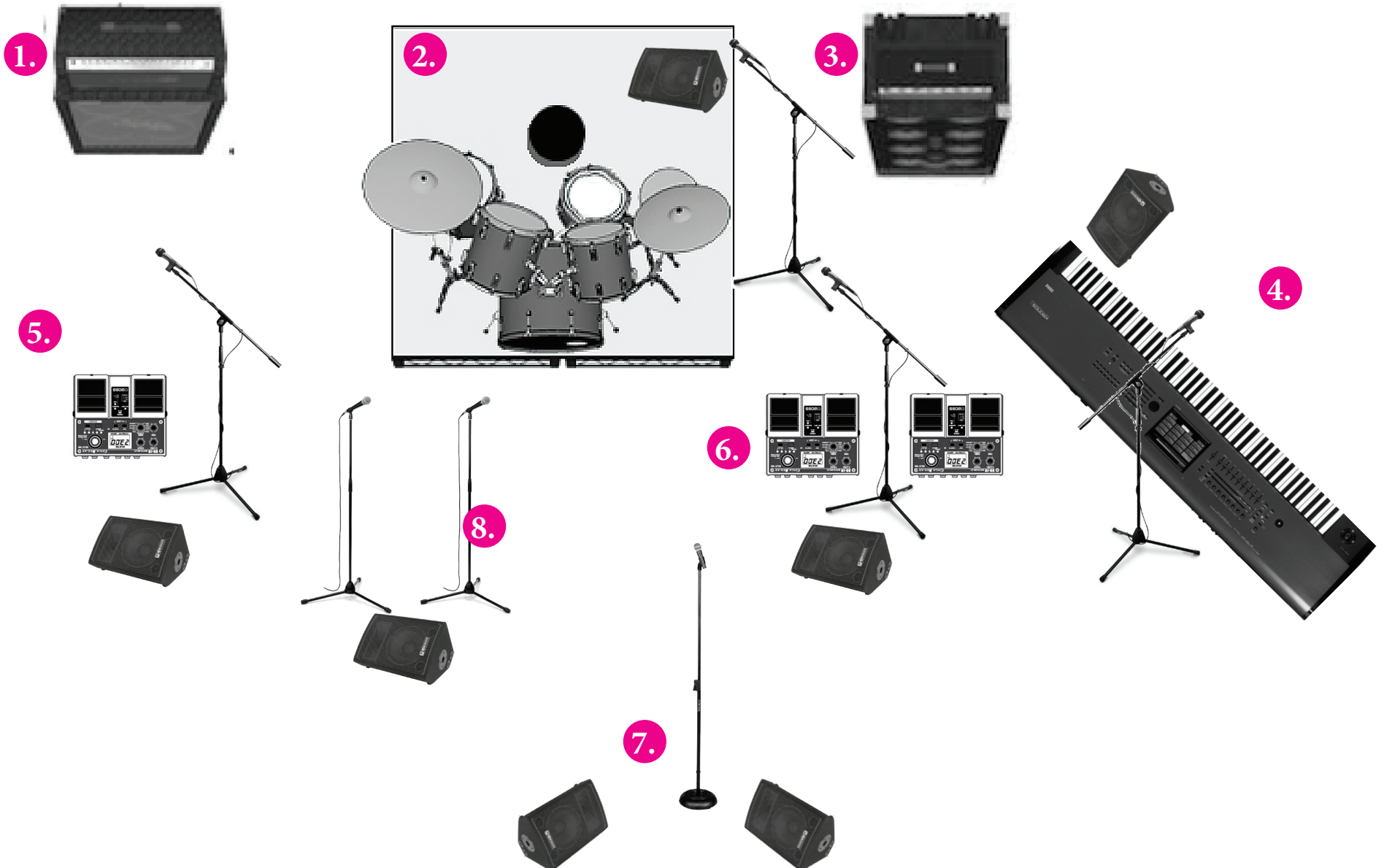



BACKLINE SPEC

– rev 101818

CONTACT INFO:

T: 323.334.0340

E: info@prismaticmusic.com

W: PrismaticMusic.com

1. GUITAR BACKLINE

- Marshall 4 x 12 Cabinet*
- Kemper Profiler Head *
- Optional Amplifiers
 - Marshall 9000
 - Carvin V3
 - 110 Edison Drop

2. DRUM SET

- Kit*
- Professional level Yamaha or DW drums:
 - 20" or 22" Bass Drum
 - 10" and 12" mounted toms
 - 16" floor tom
 - 5.5"x14" snare drum
 - 6"x14" snare drum
- Cymbals: Sabian (preferred) or Zildjian*
 - Sabian: AA, AAX, HH, or HHX models
 - Zildjian: A or A Custom models
 - 14" Medium HiHats
 - 20" or 21" Medium Light Ride
 - (2)16" and (1)18" Light Medium weight crashes
- Hardware: Heavy Duty Professional*
 - (4) boom stands
 - Snare stand
 - HiHat stand
 - Throne with bicycle style seat top
 - Longboard (preferred) or professional model chain drive or direct-drive bass drum pedal
 - 110 Edison Drop
 - Beta-57 on Boom Stand (Vox)
- Riser (if available)
 - 8' (w) x 8' (l) x 18" (h)
- Audio Monitor
 - (seperate mix if possible)

3. BASS BACKLINE

- Kemper Profiler Head*
 - Optional Amplifiers
 - Hartke 5210C
 - Aguilar Tone Hammer series
 - Gallien-Krueger RB series
 - Ampeg SVT-CL
 - Mogami XLR cable for direct-out from amp*
 - Hartke Hydrive 410/810*
 - Optional Cabinets
 - SWR Goliath series 410
 - Aguilar 410
 - Gallien-Krueger Neo or RBH 410
 - Ampeg SVT series 410/810
 - Audio Monitor – XLR/1/4" drop for IEM
 - 110 Edison Drop

4. KEYBOARD SETUP

- Korg Kronos 88-Weighted Key*
- Korg DS-1H Damper*
- Korg PS-3 Switch*
- Korg EXP-2 Volume Pedal*
- SRM-450 Monitor*
- Audio Monitor – seperate mix if possible
- Beta-58 on Boom Stand (Vox)
- 110 Edison Drop
- Riser (if available)
 - 8' (w) x 4' (l) x 12" (h)

5. GUITAR FRONTLINE

- TC Electronic Dreamscape Pedal*
- TC Electronic Flashback Delay*
- Dunlop 585 Wah*
- Audio Monitor – (seperate mix if possible)
- 110 Edison Drop for Pedal Board

6. BASS FRONTLINE

- Ibanez SR700 4-string bass guitar with* medium-gauge Elixir Nanoweb strings*
- Zoom B3.1u bass multi-effects pedal*
- (2) 25ft Mogami 1/4 cables*
- Beta-57 on Boom Stand (Vox)
- XLR Drop for Vox Synth
- 110 Edison drop for pedal board
- Audio Monitor - place wedge if IEM drop at backline cannot be accomadated.

7.

LEAD VOCAL

- Wireless Beta-58 on Round-base Stand
- (2) Audio Monitor Wedges plus XLR/1/4" drop for IEM transmitter at FOH
- (seperate mix if possible)

8.

BACKUP VOCALS

- (2) Wireless Beta-58 on Straight Stands
- (2) Audio Monitors
 - (seperate mix if possible)

* Prismatic provides for all local/touring shows



INPUT LIST

- rev 101818

CONTACT INFO:
T: 323.334.0340
E: info@prismaticmusic.com
W: PrismaticMusic.com

INPUT	INSTRUMENT	MIC	STAND	INSERT
1	Kick	B52/DM-90/D112	short boom	Gate
2	Snare	PR-22/E1/SM-57	tall boom	Gate/Comp
3	Hi Hat	SM-81/KM-184/SM-57	tall boom	
4	Rack Tom Right	E-904/D-1/SM-57	clip or tall gboom	Gate
5	Rack Tom Left	E-904/D-1/SM-57	clip or tall boom	Gate
6	Floor Tom	E-904/D-4/SM-57	clip or tall boom	Gate
7	Overhead Left	SM-81	tall boom	Gate
8	Overhead Right	SM-81409/B57/57	tall boom	Gate
9	Bass DI	XLR from head	N/A	
10	Guitar DI	XLR from head	short boom	
11	Keyboard Left	Direct Box	N/A	
12	Keyboard Right	Direct Box	N/A	
13	Lead Vox	Wireless Beta 58 or equivalent	straight round base	Comp
14	Backup Vox 1	Wireless Beta 58 or equivalent	straight round base	Comp
15	Backup Vox 2	Wireless Beta 58 or equivalent	straight round base	Comp
16	Keyboard Vox	Beta-58/SM-58	tall boom	Comp
17	Bass Vox	Beta-57/SM-57	tall boom	Comp
18	Gtr Vox	Beta-58/SM-58	tall boom	Comp
19	Drum Vox	Beta-58/SM-57	tall boom	Comp
ADDITIONAL INPUTS FOR ACOUSTIC SEGMENT (if performed)				
20	Accoustic Guitar 1	Direct Box Downstage Center		
21	Accoustic Guitar 2	Direct Box Downstage Center		
ADDITIONAL BACKLINE NEEDS FOR ACOUSTIC SEGMENT (if performed)				
4	No-back bar stools or equivalent (set-off-stage left))			
2	DI Box drop for acoustic guitars (Inputs: 20-21)			